

**Required Tools: (Not included)**

- Phillips Screwdriver
- Cutting Pliers

**⚠ WARNING**

**⚠ CAUTION:** To avoid potential shock or other injury, turn power switch OFF and disconnect charger before conducting any assembly or maintenance procedures. Failure to follow these steps in the correct order may cause irreparable damage.

**Step 1**

Using a Phillips screwdriver, remove the two (2) screws located on the charging port/power switch cover. Remove the cover with caution to the wires connected to the back of the cover.

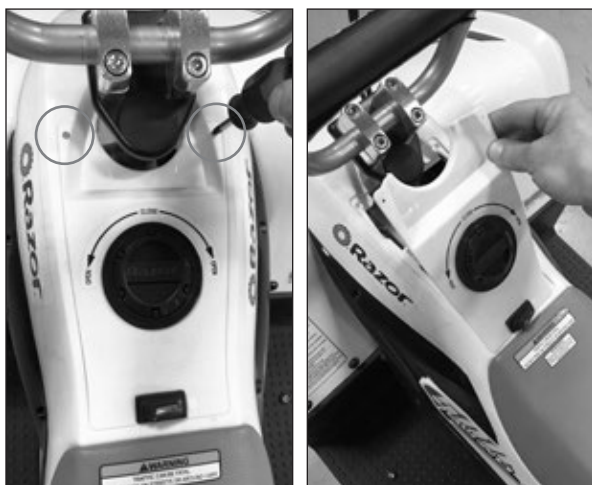
**Step 2**

On the back of the cover, locate and disconnect the black wire from the power switch.



### Step 3

Using a Phillips screwdriver, remove the two (2) screws that hold the charger port attached to the cover.



### Step 4

Locate the charger port underneath the fairing. Disconnect the charger port from the controller. Using cutting pliers, cut the zip tie that keeps all wires attached to the frame.



### Step 5

Reverse the steps to install the charger port.

**ATTENTION: Charge battery 12 hours before using.**