



# POWER CORE™ XLR 100™

## ELECTRIC HUB MOTOR SCOOTER



You must kick to accelerate to at least 3 mph (5 km/h) while pressing throttle to engage motor.

## USER GUIDE

**⚠ Read and understand this entire guide before using this product! For assistance contact Razor.**

**DO NOT RETURN TO STORE.**

Please have your product along with the 19 character product I.D. code with you before contacting Razor for warranty assistance and/or replacement parts.

Product I.D. Code: \_\_\_\_\_ - \_\_\_\_\_ - \_\_\_\_\_



# CONTENTS

Safety Warnings.....	1-2
Before You Begin.....	3
Assembly and Set-Up.....	4
Charging the Battery.....	5
Pre-Ride Checklist.....	6

Usage.....	7
Repair and Maintenance.....	8-10
Troubleshooting Guide.....	11
Electric Scooter Parts.....	12
Warranty and Contact Information.....	14

## SAFETY WARNINGS



**Always read and follow all instructions in this manual before allowing anyone to ride this electric scooter.**

**⚠ WARNING: This product moves when used. Riding electric scooters presents potential risks and it is possible to lose control and crash or to ride into potentially dangerous situations.**

**To prevent DEATH, SERIOUS INJURY, or PROPERTY DAMAGE:**

### Who Should Ride

**RECOMMENDED MINIMUM rider age is 8 years and older. DO NOT exceed maximum weight limit of 120 lb. (54 kg).**

- **ADULT SUPERVISION AND PARENTAL JUDGMENT** is essential to select riding products appropriate for children. Not every product is appropriate for every age or size of child, and different age recommendations are available for similar products intended to reflect the nature of the hazards and the expected mental or physical abilities of a child based on their parents' discretion. Adult supervision is especially important in households where different age children may have access to the same riding products. Any rider unable to fit comfortably on the scooter should not attempt to ride it.  
  
Rider age and weight are not the only factors to consider when deciding if a child should operate an electric scooter. The child must also be of an appropriate height and maturity to operate the scooter and to follow rules.
- Persons with any mental or physical conditions that may make them susceptible to injury or impair their physical dexterity or mental capabilities to recognize, understand, and perform all the safety instructions and understand the hazards inherent with scooter use should not use or be permitted to use electric scooters.
- Persons with heart conditions, pregnant women, head, back or neck ailments (or prior surgeries to these areas of the body) should not use or be permitted to use electric scooters.
- Keep scooter away from small children.

### Adult Supervision Required

- Both children and the adults responsible for their supervision while riding must recognize potentially dangerous situations and that a rider can be seriously injured or be killed even when wearing appropriate safety equipment.
- **ALWAYS** check the area where the scooter is to be operated to ensure it is suitable for safe operation.
- **ONLY** allow the use and operation of the scooter after the intended rider demonstrates understanding and operating all components of the scooter.

### What to Wear

- **ALWAYS** wear an appropriate helmet, elbow pads, and knee pads. Your helmet should be flat atop your head, not tilted back at an angle. It should fit snugly and not obstruct your field of vision. The chin strap must fit securely and remain fastened while riding. Helmets may be required by law or regulation in your area.



- **ALWAYS** wear athletic shoes (lace-up shoes with rubber soles) and keep shoelaces tied and away from wheels, motor and drive system. Never ride barefoot or when wearing sandals.

- Long-sleeved shirts, long pants, and gloves are also recommended.

### Ride at Your Own Risk and Focus on Safe Riding

- **ALWAYS** check and obey local laws or regulations which may affect the locations where the electric scooter may be used. Keep safely away from parked vehicles and from traffic at all times.

**NOTICE:** Always yield to pedestrians and follow traffic laws. Riding on the sidewalk may be illegal; consult local laws.

- **MAXIMUM speed of approximately 10 mph (16 km/h)**, which can be affected by conditions, such as rider weight, hills, and battery charge level.
- **RIDE DEFENSIVELY.** Be careful to avoid pedestrians, skaters, skateboards, scooters, bikes, children or animals who may enter your path, and respect the rights and property of others.
- **ALWAYS** hold handlebars when riding.
- **WATCH OUT** for obstacles that could catch a wheel or force you to swerve suddenly. Avoid sharp bumps, drainage grates, and other surface changes.
- **ALWAYS** ride on flat, dry surfaces, such as pavement or level ground, without loose debris, such as sand, leaves, rocks or gravel. Wet, slick, bumpy, uneven or rough surfaces may reduce traction and lead to a crash. Always brake to slow down when riding downhill.
- **DO NOT** ride your scooter in mud, ice, puddles or water. Never immerse scooter in water or electrical and drive components can be damaged.
- **DO NOT** attempt stunts or tricks when riding. Racing, stunt riding, or other maneuvers may cause loss of control, or may cause uncontrolled operator actions or reactions.
- **ONLY** one (1) rider at a time.
- **DO NOT** ride at night or in low visibility conditions.
- **DO NOT** ride in wet or icy weather.
- **NEVER** use headphones or a mobile phone while riding.
- **NEVER** use near steps or swimming pools.
- **NEVER** attempt hold to onto a moving vehicle when riding scooter.
- **DO NOT** engage motor unless you are on the scooter and in a safe, outdoor environment suitable for riding. Never risk damaging flooring or carpeting by riding indoors.
- **ALWAYS** keep hands, feet, hair, body parts, clothing, or similar articles away from wheels or other moving parts when riding.
- **DO NOT** touch brake or electric motor when in use or immediately after riding to prevent risk of burn injuries.

**Need Help?** Visit our website for replacement parts, product support, a list of authorized service centers in the US and customer service contact information at **www.razor.com**. Please have the product I.D. code (located on the white label of your product) available for better assistance. Additional Customer Service contact information is listed at the back of this manual.

# SAFETY WARNINGS

## Inspect BEFORE Riding

- ALWAYS check brake system is functioning properly.
- ALWAYS check all covers and guards are secured and in serviceable condition.
- ALWAYS check tires are in good condition, inflated properly and have sufficient tread remaining.
- ALWAYS look for any damage to scooter or tires.
- NEVER modify scooter from the manufacturer's original design and configuration.

**DO NOT ride if brake system is not functioning properly or if scooter is damaged.**

## Charging

- ONLY use the charger and battery supplied with your electric scooter. Use of any other battery or charger increases fire risk.
- ONLY adults should charge the battery. Charger is not a toy.
- DO NOT use charger near flammable materials such as dry leaves, paper, or rags.
- INSPECT charger regularly for damage to the cord, plug, enclosure and other parts. If damaged, the electric scooter must not be charged until it has been replaced. Contact RAZOR to order a replacement.
- UNPLUG charger and disconnect from scooter when not in use.
- ALWAYS disconnect charger before cleaning the electric scooter with a damp cloth.

**FAILURE TO FOCUS ON SAFE, DEFENSIVE RIDING AND FOLLOW THE ABOVE WARNINGS INCREASES YOUR RISK OF SERIOUS INJURY OR DEATH.**

**KEEP FOR FUTURE REFERENCE.**

# BEFORE YOU BEGIN

Remove contents from box. Remove the separators that protect the components from damage during shipping. Inspect the contents of the box for scratches in the paint, dents or kinked cables that may have occurred during shipping. Since the scooter comes mostly pre-assembled and securely packed at the factory, there should not be any issues, even if the box shows a few marks or dents.

**⚠ MAKE SURE POWER SWITCH IS TURNED "OFF" BEFORE STARTING ANY ASSEMBLY OR MAINTENANCE PROCEDURES.**

## ▢ Estimated Assembly and Set-Up Time

Razor recommends assembly by an adult.

Allow up to 10 minutes for assembly, not including initial charge time.

(see page 5 for charging information).

## ⚠ WARNING:

DO NOT USE NON-RAZOR PRODUCTS WITH YOUR RAZOR ELECTRIC SCOOTER. The scooter has been built to certain Razor design specifications. The original equipment supplied at the time of sale was selected on the basis of its compatibility with the frame, fork and all other parts. Certain aftermarket products may not be compatible and will void the warranty.

**NOTE: Manual illustrations are for demonstration purposes only. Illustrations may not reflect exact appearance of actual product. Specifications subject to change without notice.**

**Note: You must kick to accelerate to at least 3 mph (5 km/h) while pressing the throttle to engage motor.**

## Product ID Locations:

(See locations to the left)

1. T-bar
2. Underneath Battery Tray
3. Charger
4. UPC Side of Box (Not Shown)

## Plastic Bag Contents:

- Charger
- Allen Wrench
- User Guide

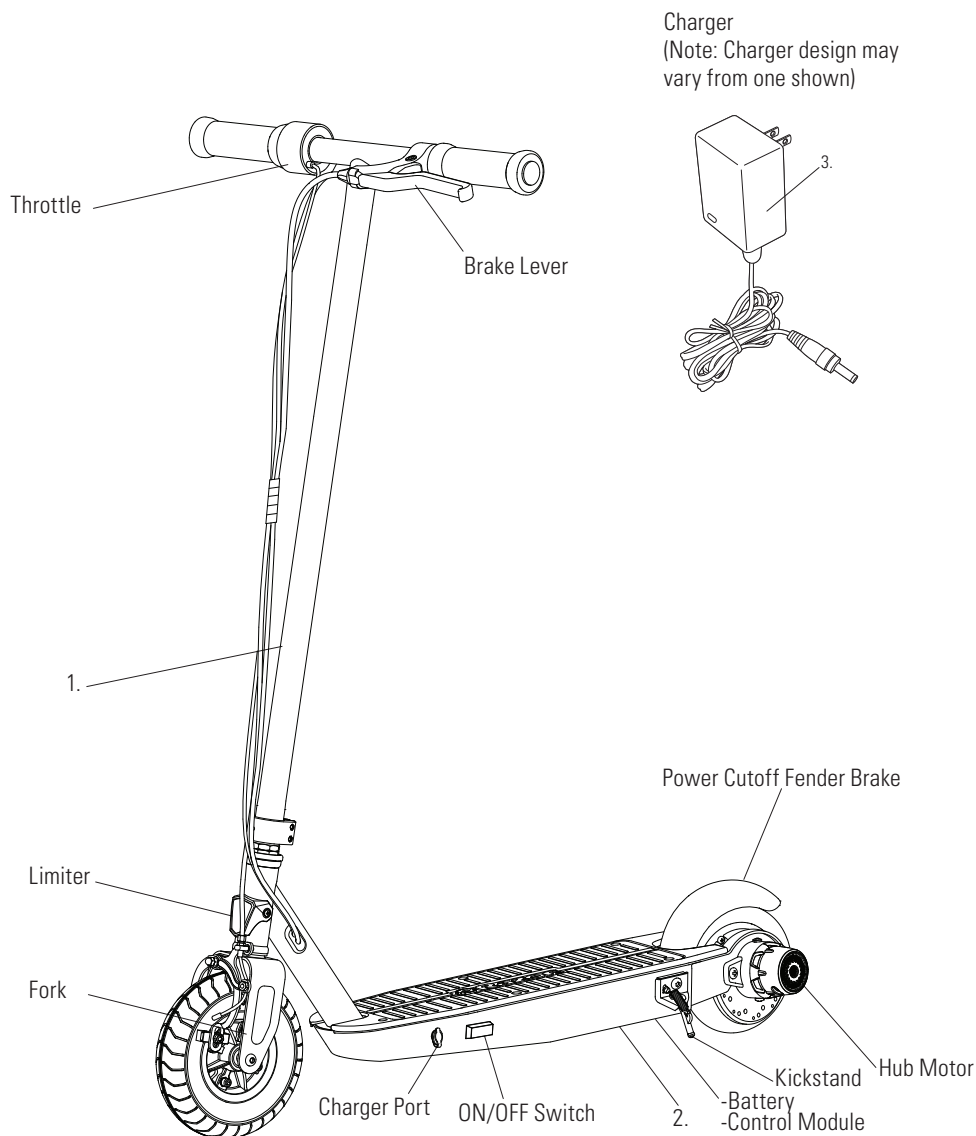

## ▢ Required Tool

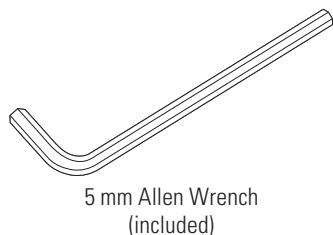

**Need Help?** Visit our website for replacement parts, product support, a list of authorized service centers in the US and customer service contact information at [www.razor.com](http://www.razor.com). Please have the product I.D. code (located on the white label of your product) available for better assistance. Additional Customer Service contact information is listed at the back of this manual.

# ASSEMBLY AND SET-UP

## □ Attaching the T-Bar

**Required Tool:** 5 mm Allen Wrench (included)

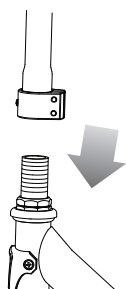

**1** Push the T-bar down on the steering tube until no threads are showing.

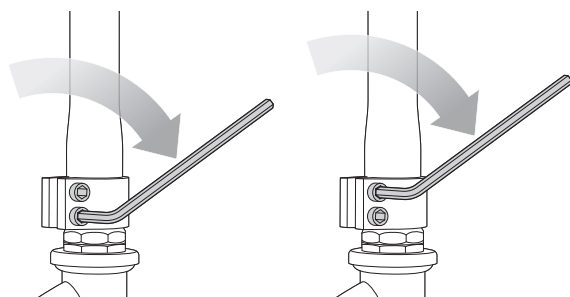
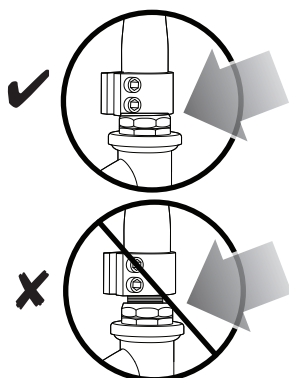

**2** With the front wheel and the handlebars aligned, tighten the clamp by alternating between both bolts until completely tight.

**Note:** Double check that both bolts are completely tightened.

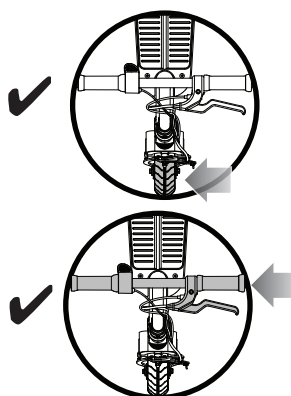

**⚠ WARNING:** Do not attempt to screw the stem into the fork thread. The stem slides over the threads and clamps in place. When properly assembled, no fork threads will be visible.

**Note:** Make sure any cables/wires are out of the way before inserting the stem into the fork. The cable and wire assembly from the handlebar must not wrap around the T-bar. Sharp bends or twisting of the brake cable can cause the brake to malfunction.

**⚠ WARNING:** Failure to properly tighten the collar clamp may allow the T-bar to dislodge while riding and may cause you to lose control and fall. When correctly tightened, the T-bar will not rotate out of alignment with the front wheel under normal circumstances.



SCAN QR CODE  
FOR ASSEMBLY &  
INSTRUCTION  
VIDEOS

## □ Inflating the Tire

The front tire is inflated when shipped but may lose some air pressure between the time it was manufactured and your purchase. **Always inflate tire to the correct PSI before first time use.**

Lower air pressure can result in a shorter ride time.  
Periodically check front tire. Reinflate when needed.

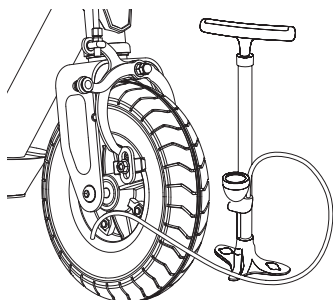

Using a bicycle-style tire pump equipped for a Schrader-type valve, inflate the front tire to the PSI indicated on the sidewall of the tire.

### ⚠ WARNING:

Do not overinflate. If you inadvertently overinflate the tire, release the excess pressure immediately.

**Note:** The pressurized air commonly available at gasoline stations is intended to inflate higher-volume automobile tires. If you decide to inflate your electric scooter tire using pressurized air instead of a bicycle-style tire pump, check that the pressure gauge attached to the air hose is working, then use very short bursts to inflate to the correct PSI.

# CHARGING THE BATTERY

Your electric scooter may not have a fully charged battery; therefore, you must charge the battery prior to use.

- Before use, charge battery until light on the charger turns green.
- Charging times may vary, however it may take up to 12 hours for the light on the charger to turn green.
- Always charge the battery immediately after riding.
- Fully charge battery before storing for extended periods of time.
- Unplug charger from the wall outlet when not in use.
- Failure to recharge battery periodically may result in a battery that will not accept a charge.
- Make sure the ON/OFF switch is turned "OFF" when product is not in use. If the power switch is left "ON" for an extended period of time, the battery may reach a stage at which it will no longer hold a charge.
- To ensure long battery life, never store the product in freezing or below freezing temperatures! If the battery freezes it will be permanently damaged.
- Run time: Up to 35 minutes of continuous ride time. Run time may vary depending on riding conditions, rider weight, climate, and/or proper maintenance.
- Repeatedly starting and stopping may shorten ride time.
- Battery life can vary depending on proper maintenance and usage of the product.

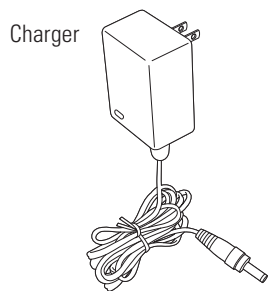

Charger design may vary from the one shown.

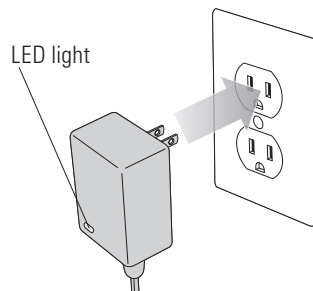

**1** Plug the charger plug into wall outlet. The light on the charger should be green.

**Note:** If green light (LED) does not turn on, try a different outlet.

Wall outlet - Green (stand by)  
Wall outlet and product- Red (charging)  
Wall outlet and product - Green (charged)

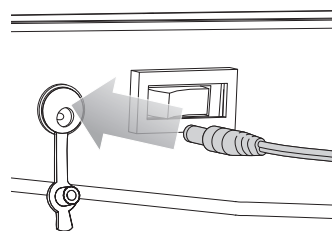

**2 Note:** Make sure power switch is in "OFF" position. Plug the charger into the charger port. The light on the charger will turn red during charging. The light will turn green again when charging is complete.

**⚠ WARNING:** ONLY use the charger supplied with your electric scooter.

ONLY adults should charge the battery. Charger is not a toy.

DO NOT use charger near flammable materials. Inspect charger regularly for damage to the cord, plug, enclosure and other parts. If damaged, the electric scooter must not be charged until it has been replaced. Contact RAZOR to order a replacement.

Unplug charger and disconnect from scooter when not in use. Always disconnect charger before cleaning the electric scooter with a damp cloth. Periodically recharge battery if scooter has not been operated recently. Battery charge can deplete over time. Periodically recharge battery when not in use.

**Note:** If the charger gets warm during regular use, this is a normal response and is no cause for concern. If your charger does not get warm during use, it does not mean that it is not working properly.

Model	Voltage (Nominal) Vdc	Capacity (Nominal) Ah	Charge Temperature Range	Operating Temperature Range
Power Core XLR 100	12	6.0	32° to 104°F 0° to 40°C	32° to 104°F 0° to 40°C

# PRE-RIDE CHECKLIST



## Brake

Check both brakes for proper function. First, squeeze the brake lever and check that the brake engages. When you apply the brake with the throttle on/engaged, the brake cut-off switch should cut power to the motor.

Next, test the fender brake. Step on the rear-fender brake and confirm that it contacts the rear wheel and provides effective stopping power. When you apply pressure to the fender brake with the throttle on/engaged, the power to the motor should be cut off and the product will slow to a stop. Ensure both braking systems operate smoothly and reliably.



## Wheels

Periodically inspect the wheels for excessive wear.



## Tire

Periodically inspect the tire for excess wear and replace as needed. Regularly check the tire pressure and inflate as needed.



## Frame, Fork and T-bar

Check for cracks or broken connections. Although broken frames are rare, it is possible for an aggressive rider to run into a curb or object and wreck, bend or break a frame. Inspect your scooter on a regular basis.



## Hardware/Loose Parts

Before every ride, check all parts, such as nuts, bolts, fasteners, etc., to ensure they are secure and assembled correctly. There should not be any unusual rattles or sounds from loose parts or broken components. If the product is damaged, do not ride. **See "Safety Warnings" on pages 1 and 2 of this user guide.**



## Safety Gear

Always wear an proper helmet, elbow pads, and knee pads. Your helmet should be flat atop your head, not tilted back at an angle. It should fit snugly and not obstruct your field of vision. The chin strap must fit securely and remain fastened while riding. Helmets may be required by law or regulation in your area. Always wear athletic shoes (lace-up shoes with rubber soles) and keep shoelaces tied and out of the way of the wheels, motor and drive system. NEVER ride barefoot or in sandals.



## Laws and Regulations

Always check and obey any local laws or regulations.



## Insurance

Your personal insurance policies may not provide coverage for crashes involving the use of this scooter/electric ride-on product. Contact your insurance company or agent to determine if you have coverage.



## Storage

Prolonged exposure to UV rays, rain and the elements may damage your product. Store indoors when not in use.



# USAGE

## Starting the Scooter

Turn power switch "ON"; put kickstand up and place both hands on the handlebars.

Place one foot on the deck plate and with the other foot, push (kick to start) scooter **while** pressing down on the thumb throttle. Place other foot on deck plate once motor has engaged.

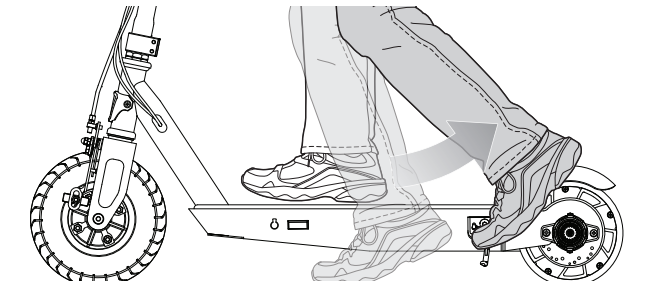
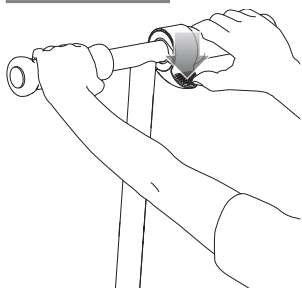

**Note:** You must kick to accelerate to at least 3 mph (5 km/h) while pressing throttle to engage motor. The product must be traveling at least 3 mph (5 km/h) before the motor will engage.



SCAN QR CODE  
FOR ASSEMBLY &  
INSTRUCTION  
VIDEOS

## How to Stop

For controlled stops, apply the brake by pressure on the rear-fender brake or squeezing the front brake lever (on handlebar). Razor recommends that you practice applying the brake options at various speeds and in an open area free from obstructions before riding your scooter around others.

Release the throttle.

**Option 1** - Squeeze the brake lever (on handlebar), the power will cut off and then product will slow to a stop.

**Option 2** - Step on the rear-fender brake, the power will cut off and then product will slow to a stop.

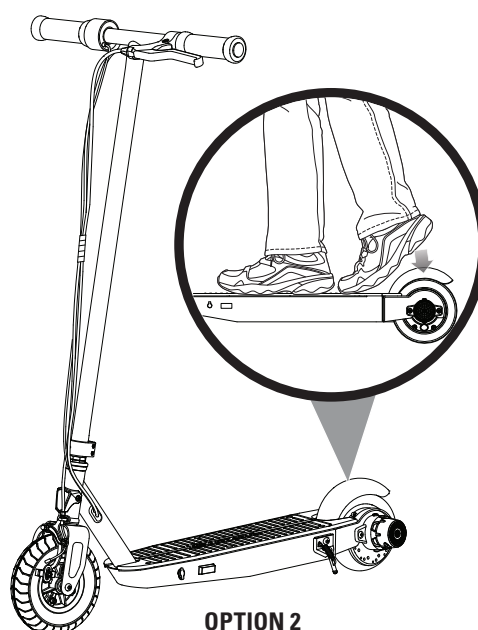
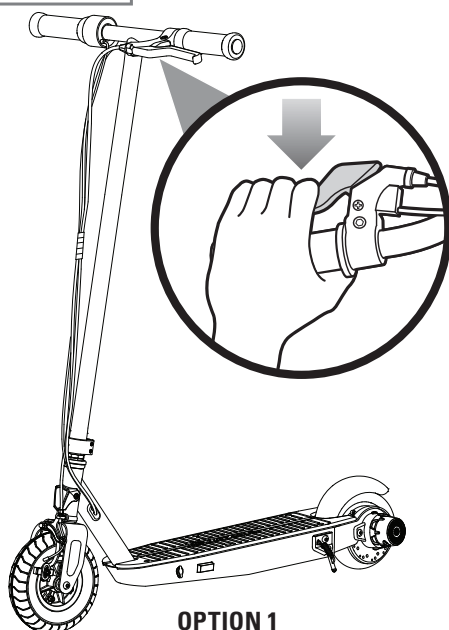

## WARNING:

The brake is capable of skidding the rear tire and throwing an unsuspecting rider. Practice in an open area free from obstacles until you are familiar with the brake function. Avoid skidding to a stop as this can cause you to lose control and/or damage the rear tire.

**Note:** As an additional safety feature, the scooter is designed to cut power to the motor when either brake option is applied.

**Note:** Motor will re-engage, (without having to kick to start), if brake is released and throttle is applied **before** scooter has slowed down to **under 3 mph (5 km/h)**.

**Note:** Practice riding only in wide open areas clear from curbs, parking blocks and other obstacles. Impacting the wheels against any hard surface can damage the wheels. Wheels are not covered under the limited warranty.

# REPAIR AND MAINTENANCE

**ALWAYS** Turn power "OFF" before beginning repair or maintenance. To prevent serious injury **ALWAYS**:

- Read the instructions.
- Remove charger plug.
- Secure the product.
- Exercise caution around exposed parts.
- Contact Razor Customer Service if unsure about any repair or maintenance.

## □ Adjusting the Front Brake

**Required Tool:** 10 mm Wrench (Not included)

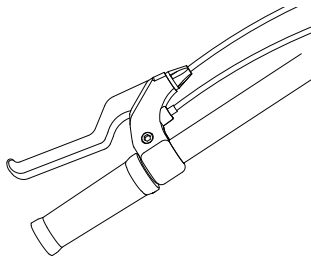

**1** To adjust brake cable play, thread the brake lever adjuster in or out 1/4 to 1/2 turn until the desired brake adjustment is attained. Most adjustments are complete at this step. If brake still needs further adjustment, proceed to step 2.

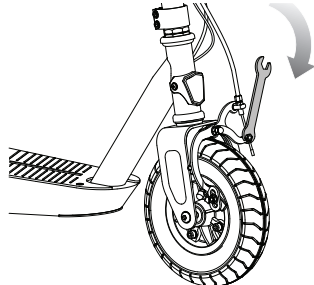

**2** If brake is too tight or has too much slack, use a 10 mm wrench to loosen the brake cable and adjust accordingly.

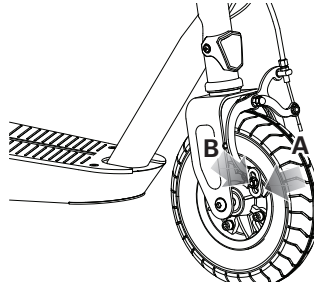

**3** Inspect the brake pads (A) for proper alignment against the wheel or excess wear. To realign brake pads, loosen the fixing nut (B) and adjust the pad to contact the rim. Re-tighten and readjust as needed. Verify proper brake function prior to riding the scooter.

## □ Front Tire Replacement

**Required Tools:** Two (2) 5 mm Allen Wrenches (Not included)

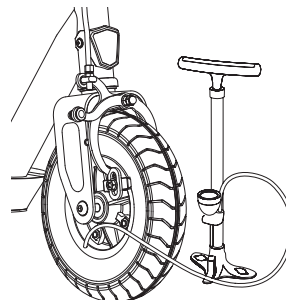
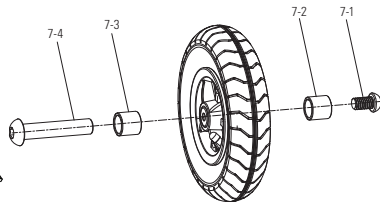
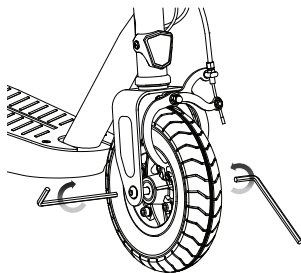

**1** Using two (2) 5 mm Allen wrenches, loosen the axle bolt. Remove wheel and install replacement wheel. (Note the sequence of the hardware)

**2** Check tire pressure. Inflate to pressure indicated on sidewall of tire.

## □ Battery/Rear Wheel/Hub Motor Replacement

**Required Tools:** Phillips Screwdriver and Two (2) 13 mm Wrenches (Not included)  
(Battery Replacement Steps 1-3)

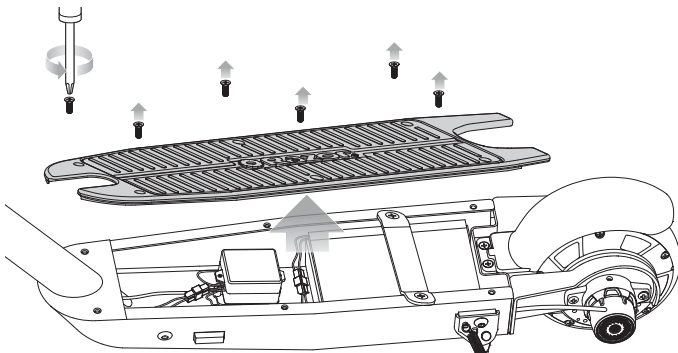

**1** Using a Phillips screwdriver remove the six (6) screws and deck plate.

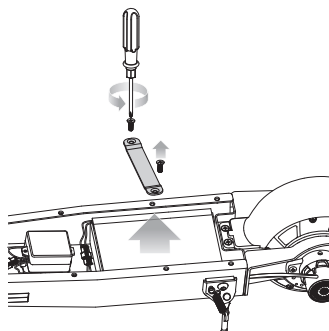

**2** Using a Phillips screwdriver remove the two (2) screws from the battery strap.

**Note:** Front wheel hardware sequence

**Right Side**  
7-2 Spacer

**Fork**  
7-1 Bolt

**Left Side**  
7-3 Spacer

**Fork**  
7-4 Coupling Bolt

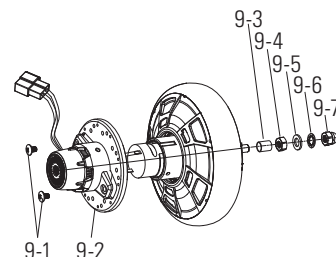

**Note:** Rear wheel/motor hardware sequence

**Left Side**  
9-1 Phillips Screws (2)  
9-2 Motor Housing

**Right Side**  
9-3 Spacer  
9-4 Nut

**Frame**  
9-5 Flat Washer  
9-6 Lock-Washer  
9-7 Locknut

# REPAIR AND MAINTENANCE

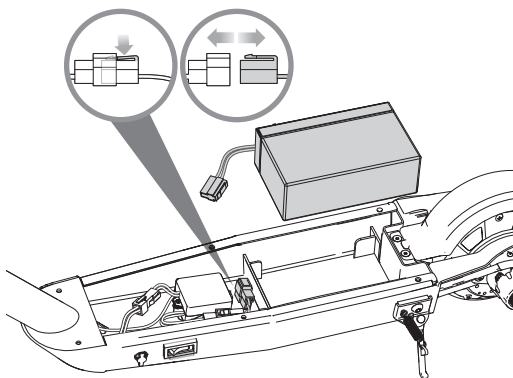

**3** Disconnect battery. To replace the battery, reverse steps 1-3.

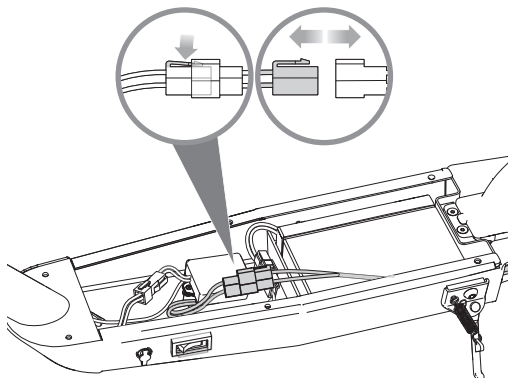

**4** Disconnect motor cables.

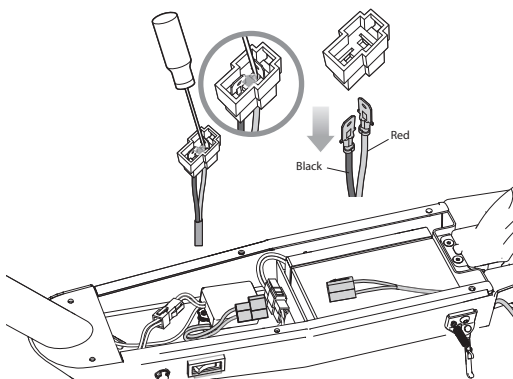

**5** Remove motor cable wires from connector using an awl.

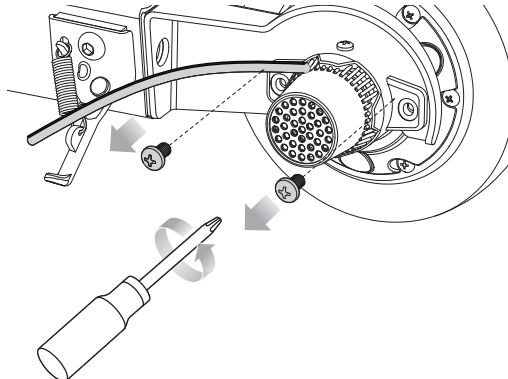

**6** Remove two (2) motor housing screws using a Phillips screwdriver.

**Note:** When re-inserting wires into motor wire connector, make sure the red wire connects to the blue wire and the black wire connects to the brown wire.

Motor		Control Module
Red wire	↔	Brown wire
Black wire	↔	Blue wire

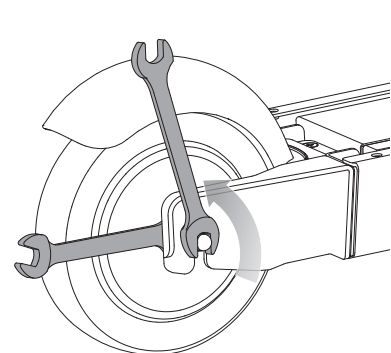

**7** Using a 13 mm wrench, loosen the outside locknut (9-7). Use a 13 mm wrench to prevent the inside nut (9-4) from turning. Remove wheel/hub motor.

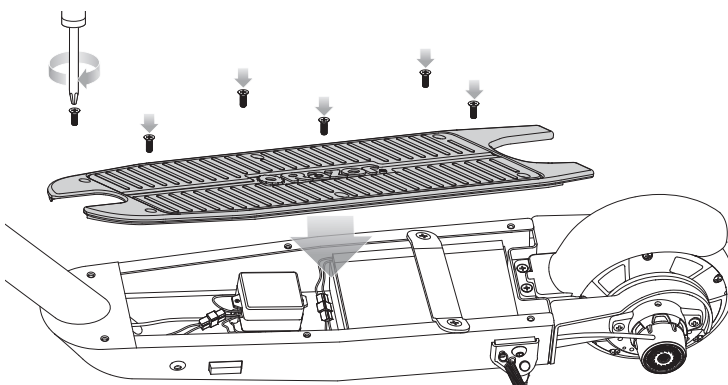
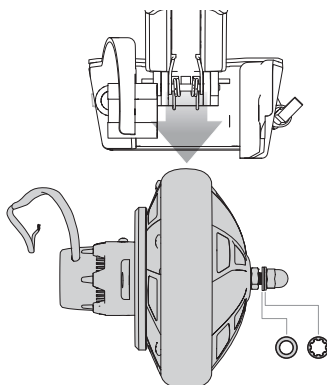

**8** To install the replacement wheel/hub motor, reverse steps 1 through 8.

**Need Help?** Visit our website for replacement parts, product support, a list of authorized service centers in the US and customer service contact information at [www.razor.com](http://www.razor.com). Please have the product I.D. code (located on the white label of your product) available for better assistance. Additional Customer Service contact information is listed at the back of this manual.

# REPAIR AND MAINTENANCE

**⚠ WARNING:** Risk of fire—no user serviceable electrical parts.

## ❑ Battery Care and Disposal

Do not store in freezing or below freezing temperatures. To properly maintain your battery and ensure maximum battery life, carefully read the “Charging the Battery” section on page 5.



CONTAINS SEALED LEAD-ACID BATTERY. BATTERY MUST BE RECYCLED.

**Disposal:** Your Razor product uses a sealed lead-acid battery which must be recycled or disposed of in an environmentally safe manner. Do not dispose of a lead-acid battery in a fire. The battery may explode or leak. Do not dispose of a lead-acid battery in your regular household trash. The incineration, land filling or mixing of sealed lead-acid batteries with household trash is prohibited by law in most areas. Return exhausted battery to a federal or state approved lead-acid battery recycler or a local seller of automotive batteries. If you live in Florida or Minnesota, it is prohibited by law to throw away lead-acid batteries in the municipal waste stream.

## ❑ Charger

The charger supplied with the electric scooter should be regularly examined for damage to the cord, plug, enclosure and other parts and in the event of such damage, the product must not be charged until it has been replaced.

Use ONLY with the recommended charger.

Not intended for use at elevations greater than 2000 m above sea level.

## ❑ Wheels

Wheels and drive system are subject to normal wear and tear. It is the responsibility of the user to periodically inspect wheels for excess wear and replace wheels and hub motor components as required.

## ❑ Replacement Parts

The most frequently requested replacement parts are available for purchase at some Razor retail partners. For the complete selection of replacement parts visit [razor.com](http://razor.com).

## ❑ Repair Centers

For a list of authorized Razor repair centers:

- Check online at [razor.com](http://razor.com).
- Customer Service Contact Information is listed on the back of this manual.



### In the US and Canada only:

For more information regarding recycling of rechargeable batteries, call toll free 1-800-822-8837, or visit <http://www.call2recycle.org>

**⚠ WARNING:** Burn hazard. If leaking battery acid, avoid contact with acid and place battery in a plastic bag. Refer to disposal instructions. If acid contacts skin or eye, flush with cool water for at least 15 minutes and seek medical attention.

# TROUBLESHOOTING GUIDE

**!** ALWAYS confirm power is turned "OFF" and fully charge battery before troubleshooting.  
Only adults should troubleshoot.

Problem	Possible Cause	Solution
Does not work out of the box	Motor will not engage	Kick to accelerate to at least 3 mph (5 km/h) while pressing down on the thumb throttle to engage motor.
	Loose connection(s)	Check for loose connections/wires underneath the deck plate.
No longer works	Loose connection(s)	Check for loose connections/wires underneath the deck plate.
	No lights on charger	Check power to wall outlet and/or try a different outlet.
	Undercharged battery	Check lights on charger: Plugged into wall - Green Plugged into wall & product - Red (charging) Plugged into wall & product - Green (charging complete) No lights/Blinking lights - Replace charger
	Battery will not hold a charge	With no weight on product, lift the back end and carefully spin rear wheel. Then press down on the throttle to engage motor. If motor engages, then replace the battery.
Short run time/runs slow	Rider's weight	Do not exceed 120 lb (54 kg) maximum weight limit.
	Riding conditions	Use only on flat, dry surfaces. Avoid inclines and areas with heavy debris.
	Battery not fully charged	Charge product for a full 12 hours.
	Old/damaged battery	Replace battery.
		Charge battery at least once a month when not in use.
		Do not store product in freezing or below freezing temperatures. If the battery freezes, it will be permanently damaged.
Runs intermittently	Loose connection(s)	Refer to Charging the Battery on page 5.
		Check the wires around the throttle and connectors underneath the deck plate.  Replace throttle.

For more troubleshooting tips, a list of available replacement parts or to locate an authorized Service Center in your area, visit our website at [www.razor.com](http://www.razor.com) or call toll free +1 866-467-2967 to speak to a live Customer Service Representative.

# ELECTRIC SCOOTER PARTS

Keep your electric scooter running for years with genuine Razor parts.  
(Specifications subject to change without notice.)

1. Grips (Right/Left)
2. Throttle
3. T-bar
4. Brake Lever
5. Collar Clamp
6. Headset (Upper/Lower)
7. Fork
8. Brake Caliper
9. Front Wheel Complete (See Pg. 7 For Hardware Sequence)
10. Rear-Fender Brake
11. Rear Wheel with Motor Complete (See Pg. 7 For Hardware Sequence)
12. Control Module
13. Battery (1-12V/6Ah)
14. Charger Port
15. ON/OFF Switch
16. Kickstand

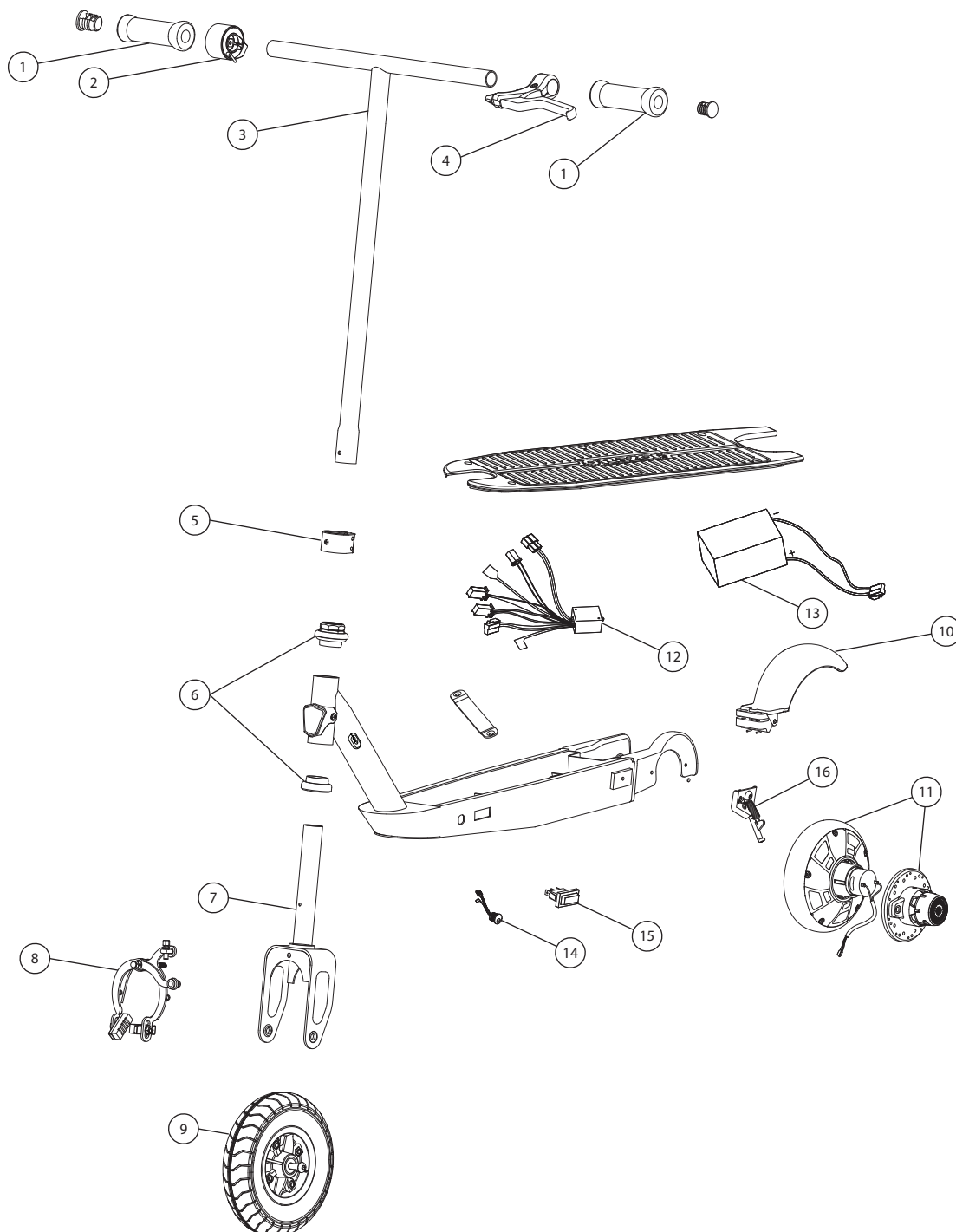

**Need Help?** Visit our website for replacement parts, product support, a list of authorized service centers in the US and customer service contact information at [www.razor.com](http://www.razor.com). Please have the product I.D. code (located on the white label of your product) available for better assistance. Additional Customer Service contact information is listed at the back of this manual.

**NOTICE: INSURANCE**

**YOUR INSURANCE POLICIES MAY NOT PROVIDE COVERAGE FOR ACCIDENTS INVOLVING THE USE OF THIS SCOOTER/ELECTRIC RIDE-ON PRODUCT. TO DETERMINE IF COVERAGE IS PROVIDED, YOU SHOULD CONTACT YOUR INSURANCE COMPANY OR AGENT.**



## FCC COMPLIANCE

This device complies with Part 15 of the FCC Rules. Operation is subject to the following two conditions: (1) This device may not cause harmful interference, and (2) this device must accept any interference received, including interference that may cause undesired operation.

Note: This equipment has been tested and found to comply with the limits for a Class B digital device, pursuant to part 15 of the FCC Rules. These limits are designed to provide reasonable protection against harmful interference in a residential installation. This equipment generates, uses and can radiate radio frequency energy and, if not installed and used in accordance with the instructions, may cause harmful interference to radio communications. However, there is no guarantee that interference will not occur in a particular installation. If this equipment does cause harmful interference to radio or television reception, which can be determined by turning the equipment off and on, the user is encouraged to try to correct the interference by one or more of the following measures:

- Reorient or relocate the receiving antenna.
- Increase the separation between the equipment and receiver.
- Connect the equipment into an outlet on a circuit different from that to which the receiver is connected.
- Consult the dealer or an experienced radio/TV technician for help.

## WARRANTY

### Razor Limited Warranty

The manufacturer warrants this product to be free of manufacturing defects for a period of 90 days from date of purchase. This Limited Warranty does not cover normal wear and tear, wheel, tire, tube or cables or any damage, failure or loss caused by improper assembly, maintenance, storage or use of the electric scooter.

This Limited Warranty will be void if the product is ever:

- used in a manner other than for recreation or transportation;
- modified in any way or
- rented.

The manufacturer is not liable for incidental or consequential loss or damage due directly or indirectly to the use of this product.

**⚠ WARNING: Never attempt to modify or alter this product unless expressly approved by Razor USA LLC.**

Razor does not offer an extended warranty. If you have purchased an extended warranty, it must be honored by the insurance provider from which it was purchased.

For your records, save your original sales receipt with this manual and write the serial number below.

\_\_\_\_\_

## CUSTOMER SERVICE CONTACT INFORMATION

**Need Help?** Visit our website for product support, a list of authorized service centers in the US and customer service contact information at **[www.razor.com](http://www.razor.com)**. Please have the product I.D. code (located on the white label of your product) available for better assistance. Additional Customer Service contact information is listed below:

### AMERICAS

Razor USA LLC  
P.O. Box 3610  
Cerritos, CA 90703  
USA

+1 866 467 2967  
Monday - Friday  
8:00 AM - 5:00 PM Pacific Time  
[customersupport@razorusa.com](mailto:customersupport@razorusa.com)

### EUROPE, MIDDLE EAST, AFRICA

Razor USA LLC (Europe)  
Handelsweg 2  
2742 RD Waddinxveen  
Netherlands

+44 (0) 120 267 2702  
[info@razoreu.com](mailto:info@razoreu.com)

### ASIA

Razor USA LLC (Asia)  
P.O. Box 3610  
Cerritos, CA 90703  
USA

+81 50 7579 6622  
[info@razor-asia.com](mailto:info@razor-asia.com)

### UNITED KINGDOM AND IRELAND

Razor USA LLC (UK)  
Unit 20  
Hartnoll Business Centre  
Post Hill, Tiverton  
Devon EX16 4NG  
UK

+44 (0) 120 267 2702  
[info@razoreu.com](mailto:info@razoreu.com)

### AUSTRALIA AND NEW ZEALAND

Razor USA LLC  
P.O. Box 4280  
Auburn South  
VIC 3122  
Australia

+1 800 954 354  
[info@razoranz.com](mailto:info@razoranz.com)

### IMPORTED IN JAPAN BY B-PLUS ASIA CORP.

Razor USA LLC  
**THE FIRSTIK COMPANY**  
Kurokawa 3-1, Asaoku,  
Kawasaki, Kanagawa  
215-0035 JAPAN

+81 (0) 44 328 9057 Tel  
+81 (0) 44 328 9067 Fax  
[info@razor-asia.com](mailto:info@razor-asia.com)

Printed in China for Razor USA LLC.

Copyright © 2003-2026 Razor USA, LLC. All rights reserved. Razor® and the Razor logo design are among the registered trademarks of Razor USA LLC in the United States and/or select foreign countries. Power Core™ and the Power Core™ XLR 100 logo design are trademarks of Razor USA LLC.

US\_251218