



## DIRT QUAD POWER SWITCH INSTALLATION REPLACEMENT INSTRUCTIONS

PART # W15128050101

PART # W25143065101

### Required Tools: (Not included)

- 5 mm Allen wrench
- Phillips screwdriver
- 13 mm open wrench
- 10 mm open wrench
- Flat screwdriver

### WARNING

**⚠ CAUTION:** To avoid potential shock or other injury, turn power switch OFF and disconnect charger before conducting any assembly or maintenance procedures. Failure to follow these steps in the correct order may cause irreparable damage.

### Step 1

Using a 5 mm Allen wrench, remove the four (4) bolts located on the footrest.

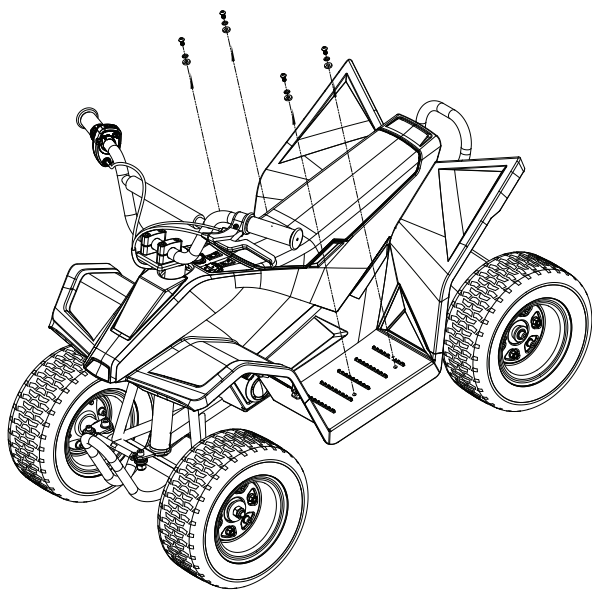

### Step 2

Using a Phillips screwdriver, remove the two (2) screws on both the left and right sides of the front of the unit.

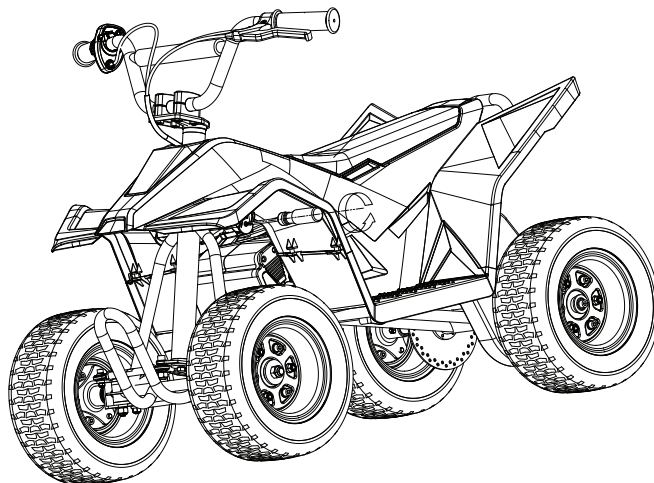

### Step 3

Using a 13 mm open wrench, loosen and remove the bolt from the steering arm that connects it to the steering tube.

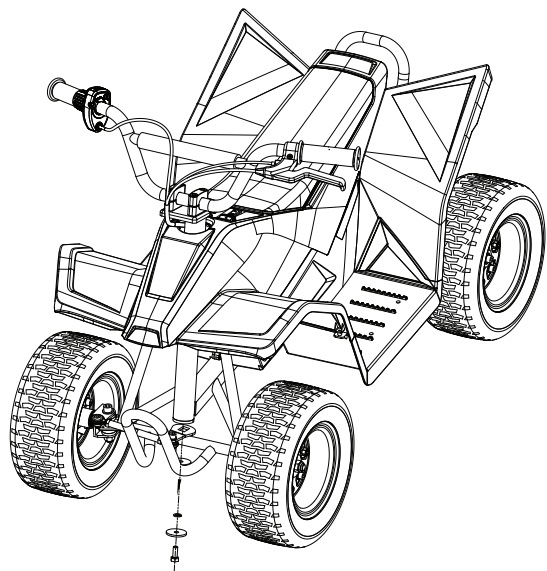

### Step 4

Using a 10 mm open wrench, remove the two (2) lock nuts under the seat.

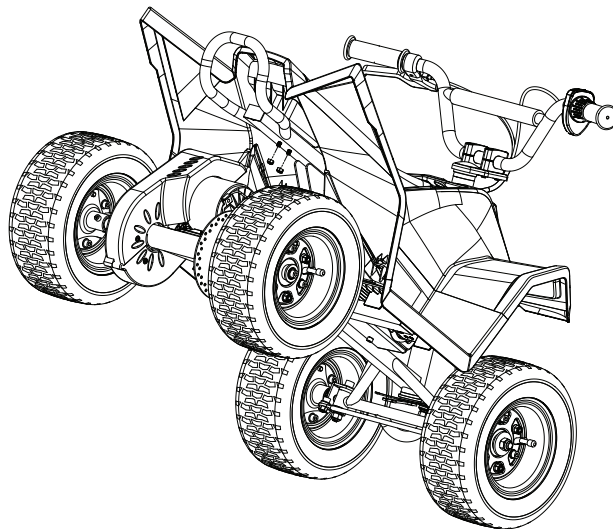

### Step 5

Lift and remove the steering tube from the frame. The brake cable may need to be disconnected from the caliper.

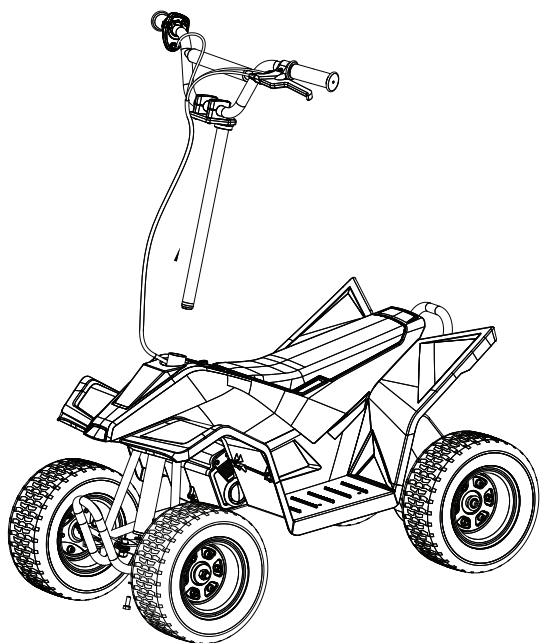

### Step 6

Lift and remove the body fairing from the unit and unplug the connectors between the battery and the controller.

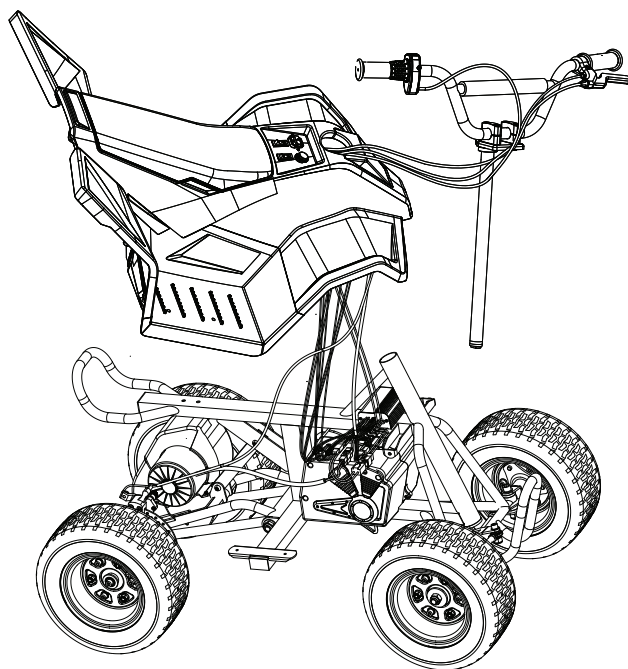

## Step 7

Disconnect the connectors from the power switch.

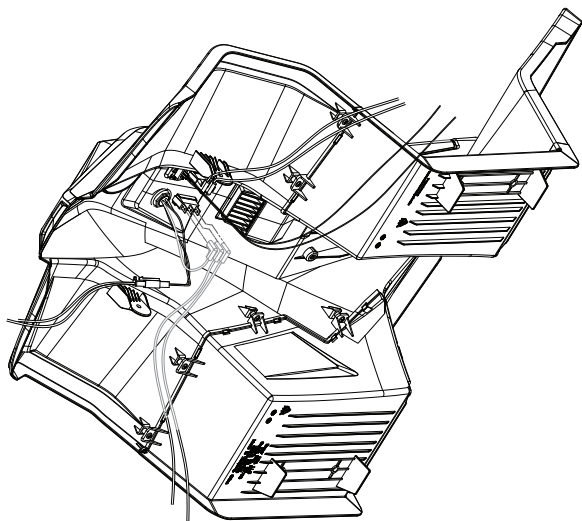

## Step 8

Using a flat screwdriver, remove the glue on the back of the power switch. Remove the power switch from the body fairing.

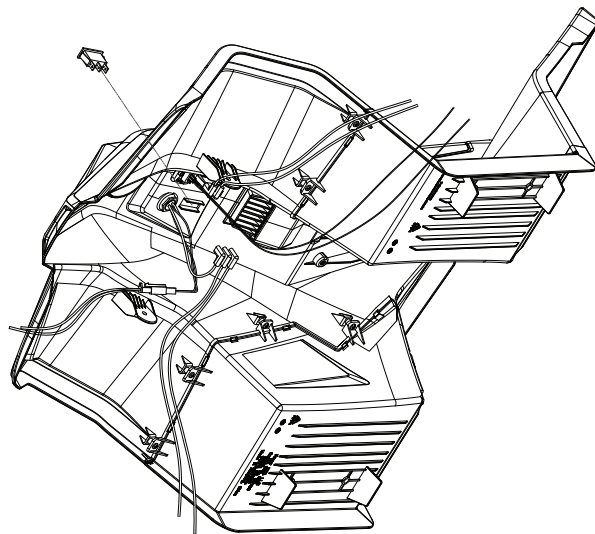

## Step 9

To install a new power switch, reverse steps 1-8.

**ATTENTION: Charge battery 12 hours before using.**