

Required Tools: (Not included)

- 3mm Allen wrench
- Phillips screwdriver

⚠ WARNING

⚠ CAUTION: To avoid potential shock or other injury, turn power switch **OFF** and disconnect charger before conducting any assembly or maintenance procedures. Failure to follow these steps in the correct order may cause irreparable damage.

Step 1

Remove the grip from the handlebar, then use a 3mm Allen Wrench to loosen the set screw on the throttle.

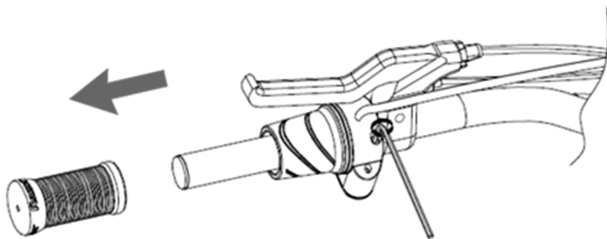
**Step 2**

Using a Phillips screwdriver, remove the screws from the battery cover and open the cover. Locate and disconnect the throttle from the controller.

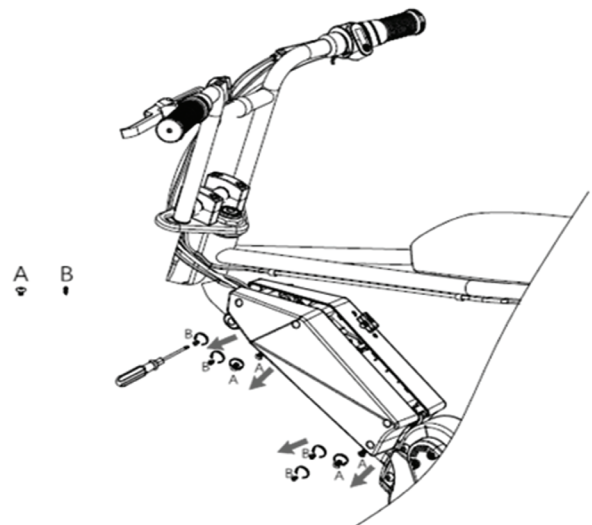

Step 3

Remove the throttle from the handlebar.

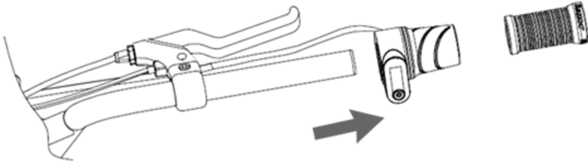

Step 4

Install the new throttle and reassemble the grip onto the handlebar.

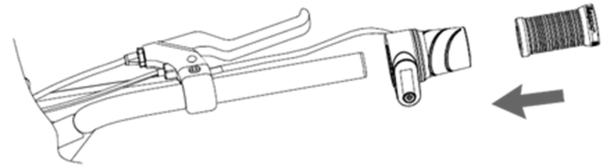

Step 5

Using a 3mm Allen wrench, tighten and secure the throttle set screw.

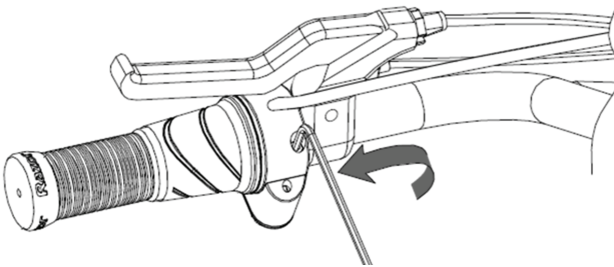

Step 6

Close the battery cover and reattach the screws.

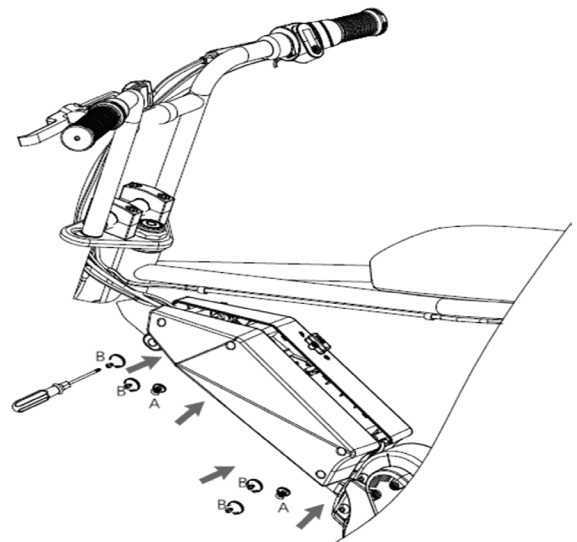

ATTENTION: Charge battery 12 hours before using.