



**GROUND FORCE RAD ROD  
HIGH/LOW SPEED SWITCH  
REPLACEMENT INSTRUCTIONS**  
PART # W25141001280

**Required Tools: (Not included)**

- A. 5 mm Allen Wrench
- B. Phillips Screwdriver

**⚠ WARNING**

**⚠ CAUTION:** To avoid potential shock or other injury, turn power switch **OFF** and disconnect charger before conducting any assembly or maintenance procedures. Failure to follow these steps in the correct order may cause irreparable damage.

**Step 1**

Remove the flag. Use a 5 mm Allen wrench to remove four (4) screws on the seat, then remove the seat.

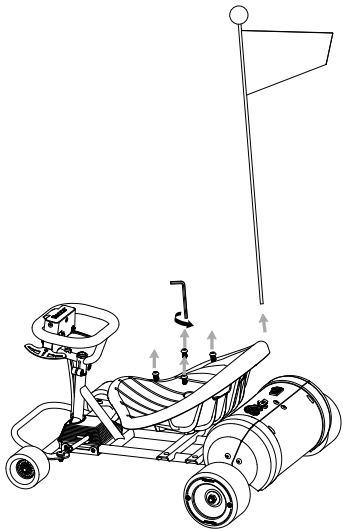

**Step 2**

Use a Phillips screwdriver to remove five (5) screws on the rear battery cover.

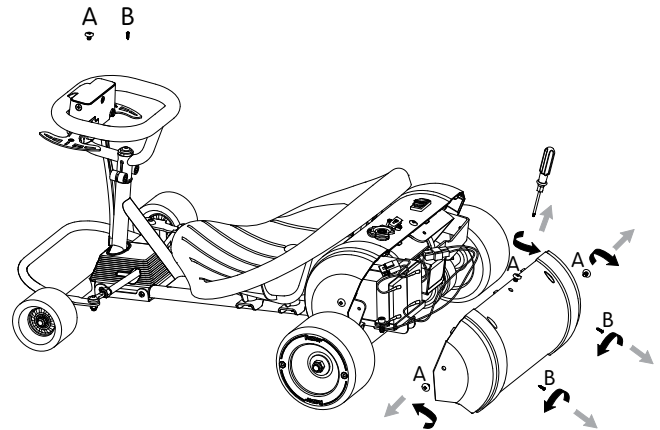

### Step 3

Use a Phillips screwdriver to remove three (3) screws on the front battery cover. Disconnect the plugs and remove the front cover.

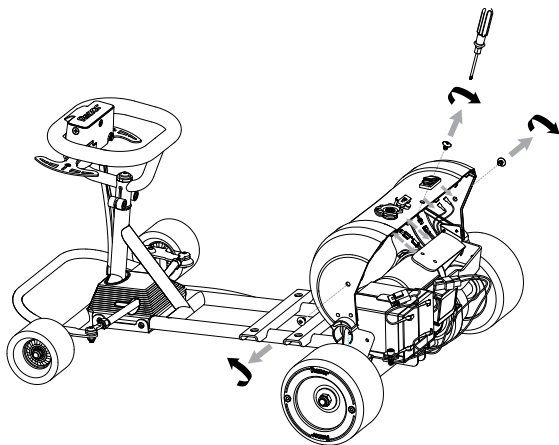

### Step 4

Remove the glue around the HIGH/LOW speed switch. Use a Phillips screwdriver to remove two (2) tapping screws A & B on the HIGH/LOW speed switch cover.

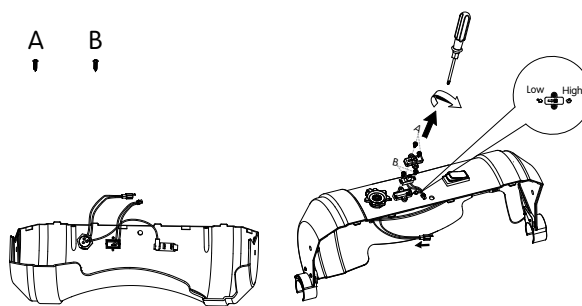

### Step 5

To install a new HIGH/LOW speed switch, reverse steps 1 through 4.

**ATTENTION: Charge battery 8 hours before using.**

