

Required Tool: (Not included)

A. 6 mm Allen Wrench

⚠ WARNING

⚠ CAUTION: To avoid potential shock or other injury, turn power switch OFF and disconnect charger before conducting any assembly or maintenance procedures. Failure to follow these steps in the correct order may cause irreparable damage.

Step 1

Using a 6 mm Allen wrench, loosen the four (4) bolts on the handlebar clamps. Remove handlebar.

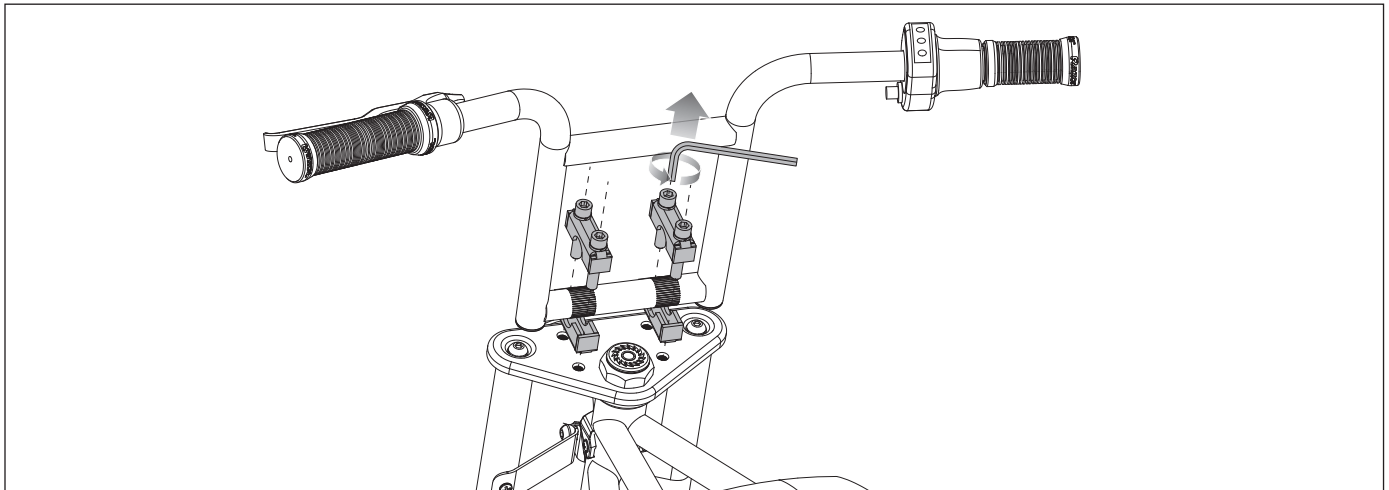

Step 2

Place the handlebar in the handlebar clamps. Align parallel to the fork and tighten the bolts using a 6 mm Allen wrench. When properly tightened, the handlebar should not move forward or backward.

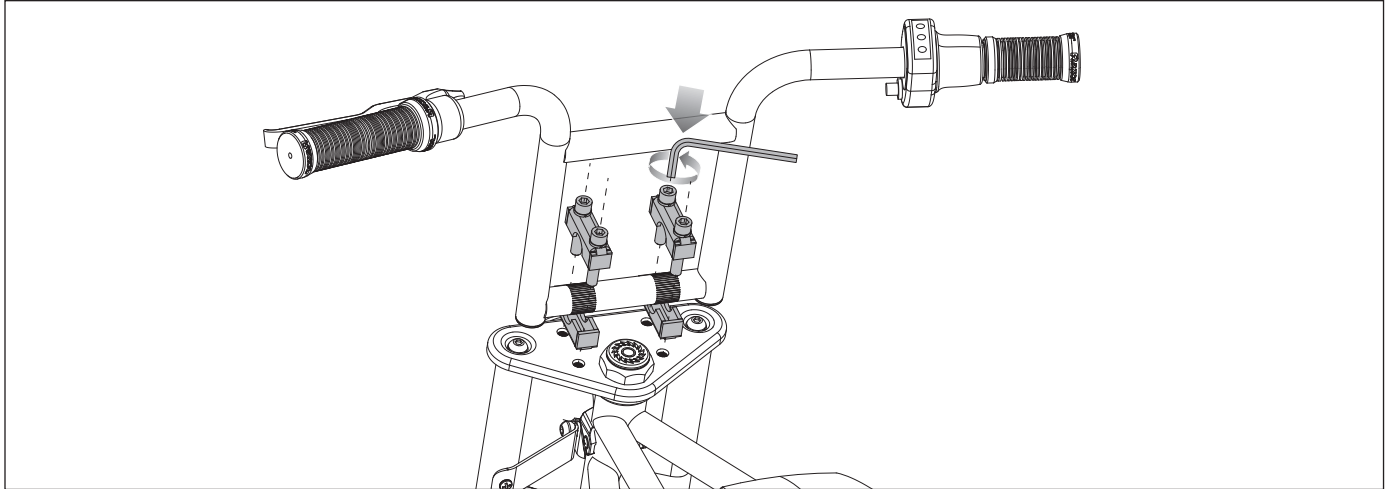
**Step 3**

Reverse the steps.

ATTENTION: Charge battery 12 hours before using.