

Required Tools: (Not included)

- Phillips Screwdriver
- 5 mm Allen Wrench
- 4 mm Allen Wrench

⚠ WARNING

⚠ CAUTION: To avoid potential shock or other injury, turn power switch **OFF** and disconnect charger before conducting any assembly or maintenance procedures. Failure to follow these steps in the correct order may cause irreparable damage.

Step 1

Remove the flag from the seat. Using a 5 mm Allen wrench, remove the four (4) screws from the seat. Set the flag and seat aside.

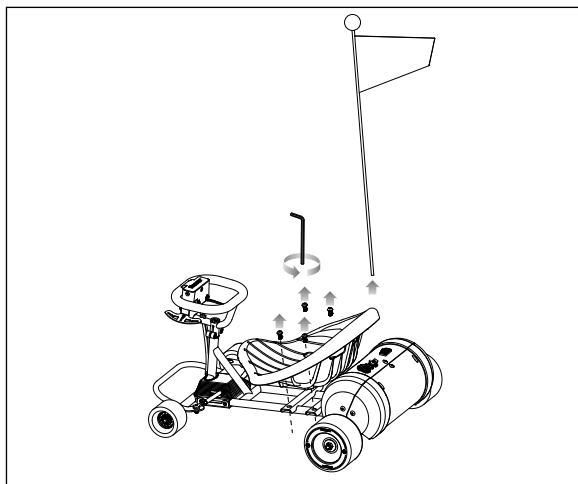
**Step 2**

Using a Phillips screwdriver, remove the five (5) screws from the rear battery cover. Set the rear cover aside.

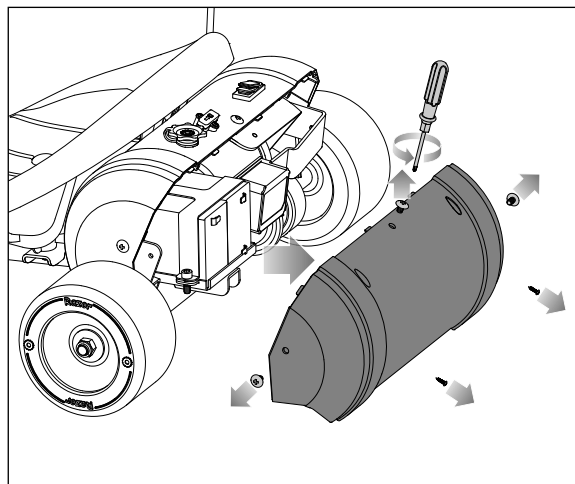

Step 3

Using a Phillips screwdriver, remove the three (3) screws from the front battery cover.

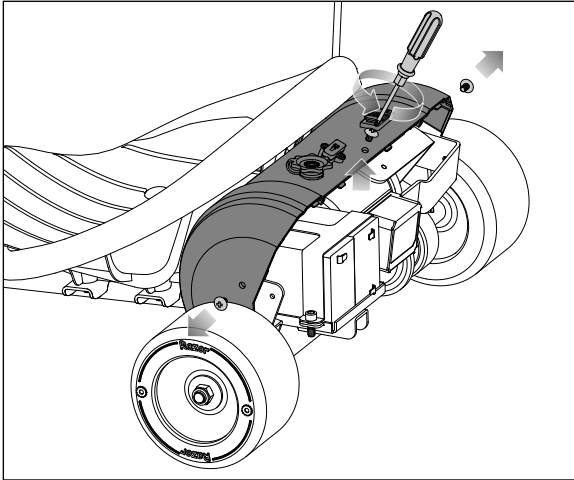

Step 4

Disconnect the plugs from the front cover. Set the front cover aside.

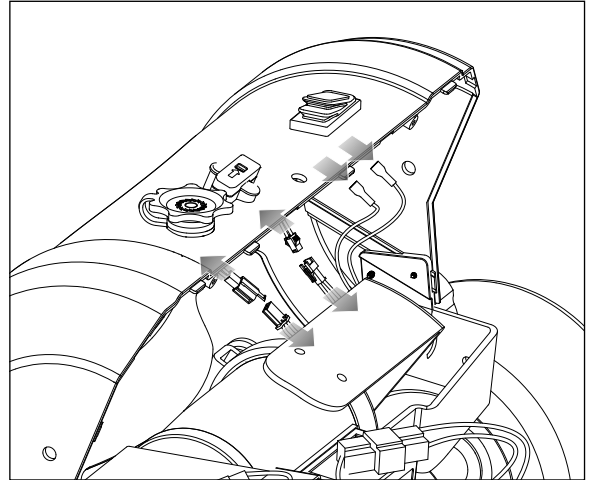

Step 5

Using a 4 mm Allen wrench, remove the two (2) screws from the battery strap. Disconnect the plug between the battery and controller.

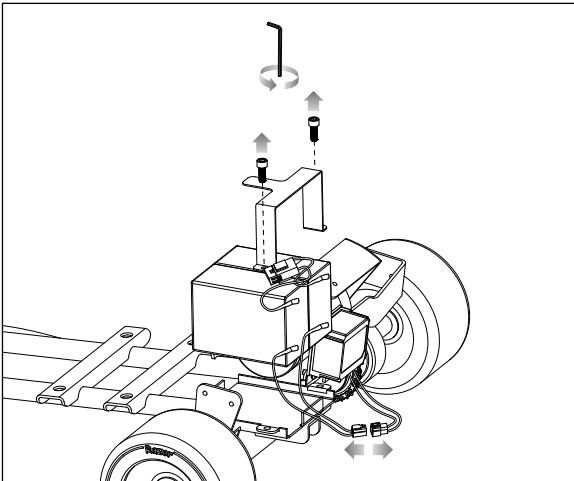

Step 6

Using a Phillips screwdriver, remove the three (3) screws from the motor. Disconnect the plug between the motor and the controller. Remove the motor.

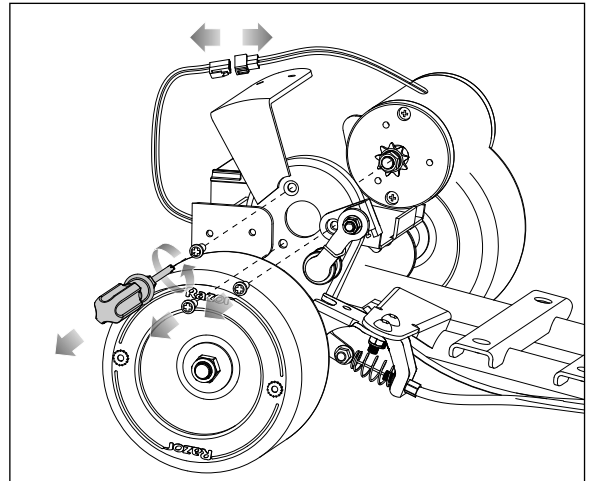

Step 7

Assemble the chain on the new motor and tensioner. Using a Phillips screwdriver, replace the three (3) screws on the motor. Connect the plug between the motor and the controller.

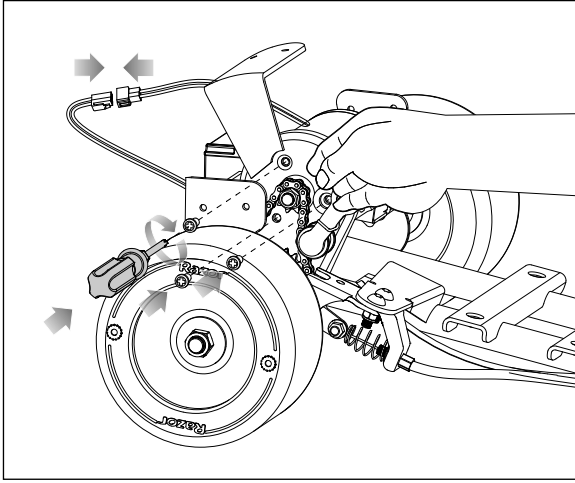

Step 8

Reverse steps 1 through 5 to complete assembly.

ATTENTION: Charge battery 8 hours before using.

