

Required Tools: (Not included)

- 15mm open-end wrench
- Phillips Screwdriver
- Two (2) 5mm Allen wrenches
- Pliers

⚠ WARNING

⚠ CAUTION: To avoid potential shock or other injury, turn power switch **OFF** and disconnect charger before conducting any assembly or maintenance procedures. Failure to follow these steps in the correct order may cause irreparable damage.

Step 1

Using a Phillips screwdriver, remove the six (6) screws on the battery cover.

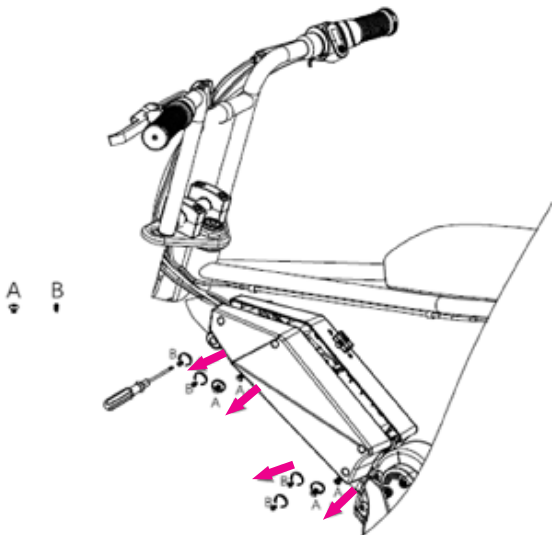
**Step 2**

Unplug the four (4) connectors (the connector between controller and thermistor; the connector between controller and motor; the connector between controller and speed transmitter; the connector between controller and wheel speed sensor).

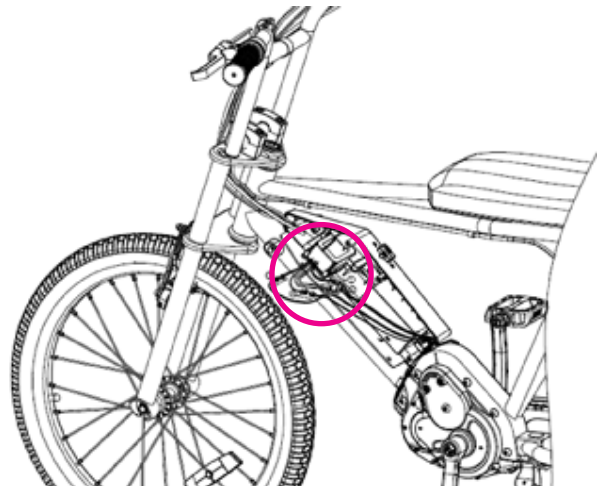

Step 3

Remove the chain link plate with pliers.

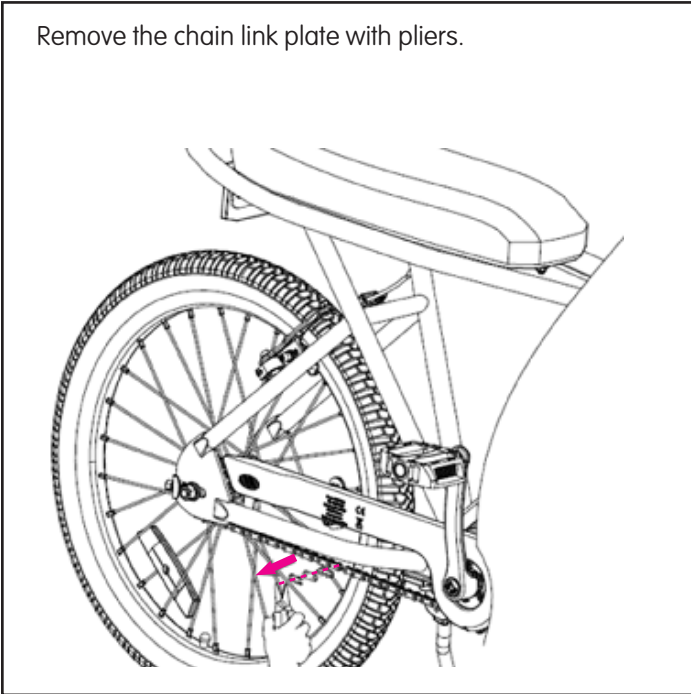

Step 4

Using a Phillips screwdriver, remove the two (2) screws from the chain cover. Remove the chain cover and the chain.

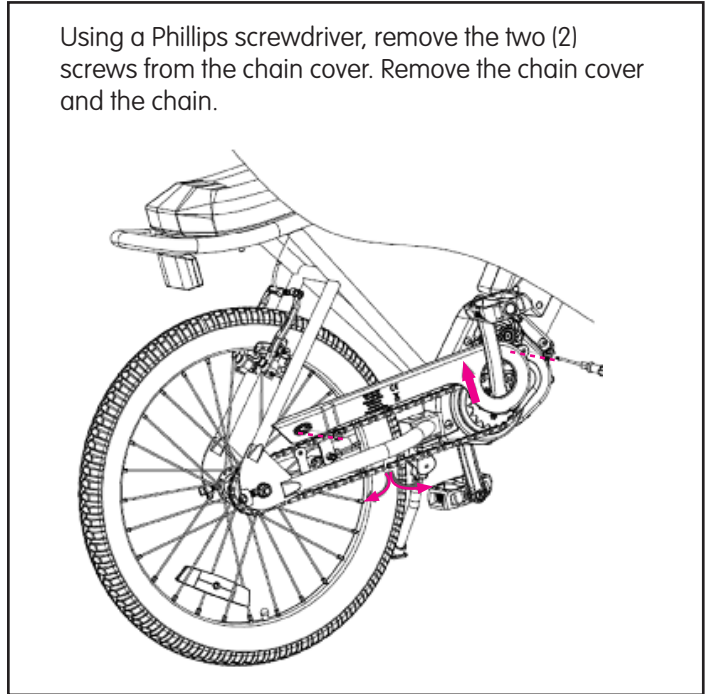

Step 5

Using a 15mm open-end wrench, remove the left and right pedals. Using two (2) 5mm Allen wrenches, remove the five (5) coupling bolts that hold the motor in place.

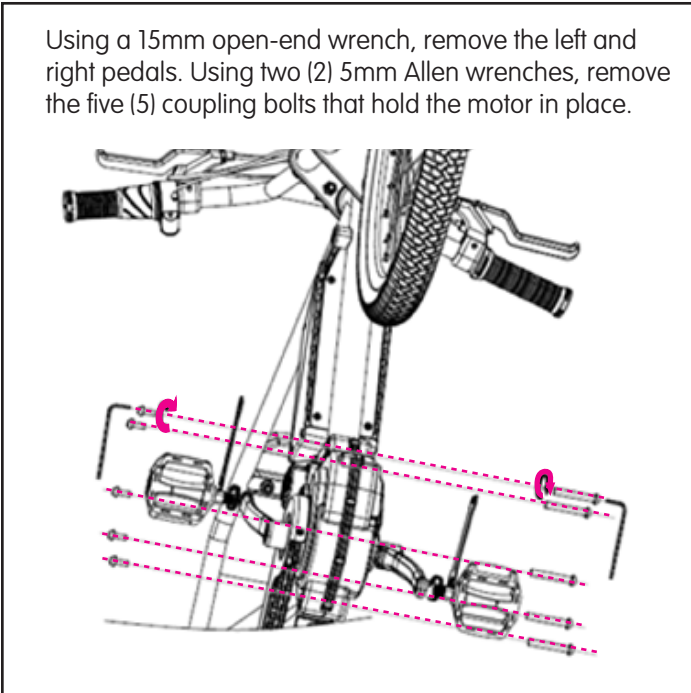

Step 6

Using a Phillips screwdriver, remove the two (2) screws on the cover of the motor wire, then remove the cover.

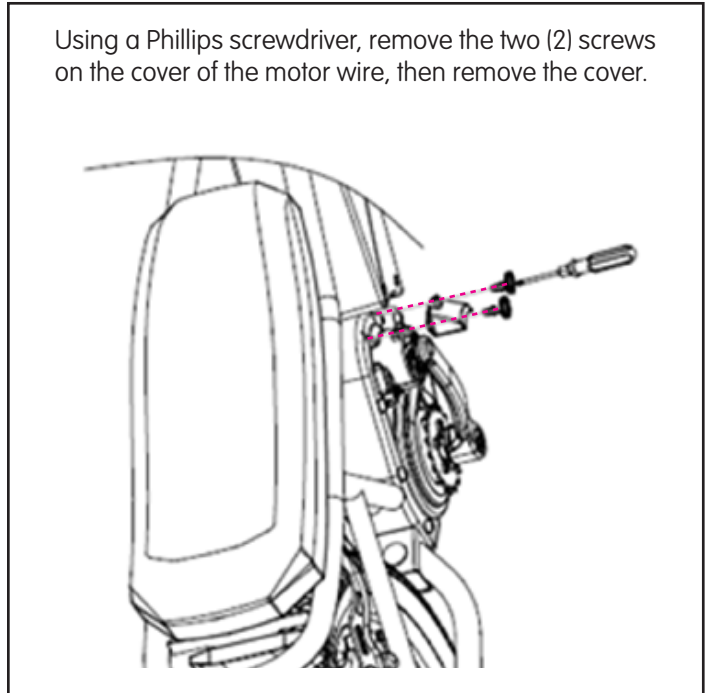

Step 7

Using a Phillips screwdriver, remove the screw on the wheel speed sensor, then remove the wheel speed sensor.

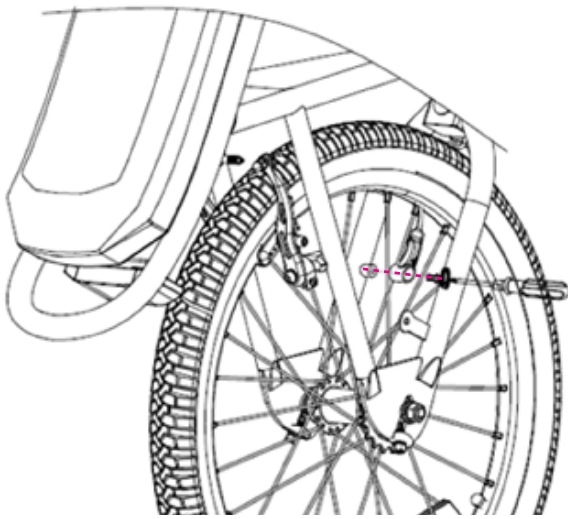

Step 8

Remove the motor from the frame.

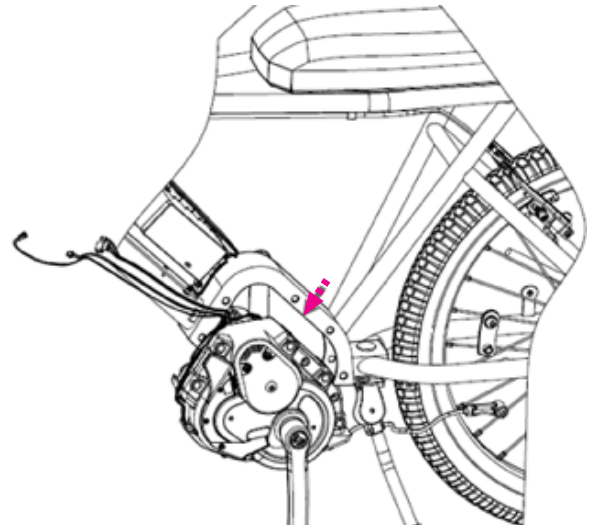

Step 9

Insert a new motor, then reverse steps 1 through 8.

ATTENTION: Charge battery 12 hours before using.