



**RAMBLER 20**  
**REAR WHEEL - MOTOR**  
**REPLACEMENT INSTRUCTIONS**  
PART # W15128778048

**Required Tools: (Not included)**

- A. Phillips screwdriver
- B. 10 mm wrench
- C. 21 mm wrench

**⚠ WARNING**

**⚠ CAUTION:** To avoid potential shock or other injury, turn power switch OFF and disconnect charger before conducting any assembly or maintenance procedures. Failure to follow these steps in the correct order may cause irreparable damage.

**Step 1**

Using a Phillips screwdriver, remove two (2) screws located under the seat at the back of the unit.

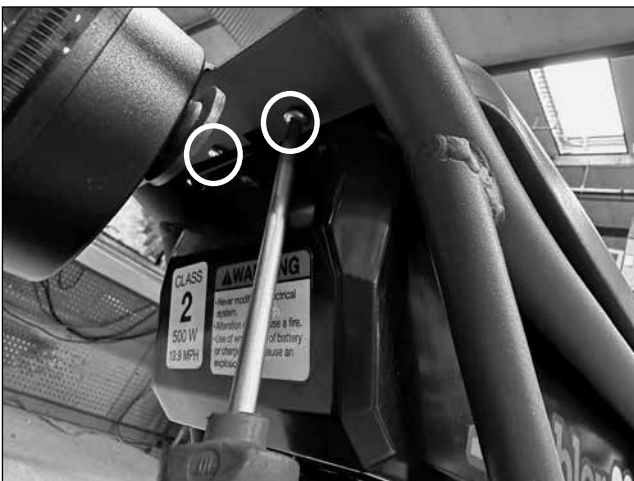

**Step 2**

Lift and pull back on the seat to remove.



### Step 3

Locate and disconnect all the motor connectors from the controller.



### Step 4

Using a Phillips screwdriver, remove the three (3) screws that hold the chain guard in place. Remove the chain guard.

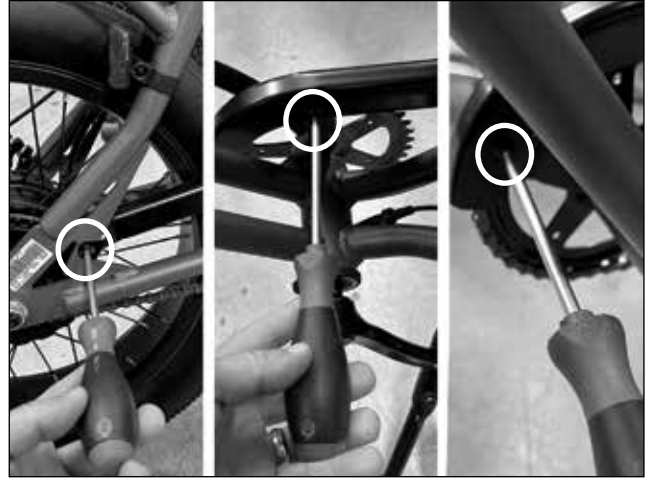

### Step 5

Unthread and remove the end cap from the chain tensioner bolt on both sides of the frame.

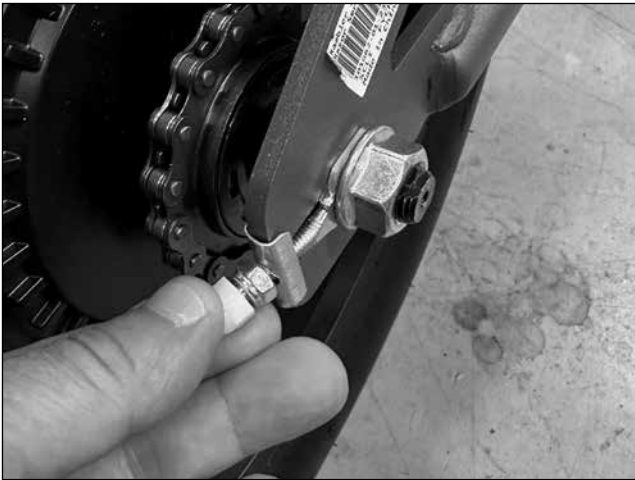

### Step 6

Using a 10 mm wrench, loosen and remove the lock nut from the chain tensioner bolt on both sides of the frame.



## Step 7

Using two (2) 21 mm wrenches, loosen the lock nuts from the rear axle.



## Step 8

Push the wheel forward to create slack on the chain. Dismount the chain from the front sprocket and then the rear. With that chain out of both sprockets, pull the wheel back and out the frame.



## Step 9

To install new Rear Wheel, Motor, reverse steps 1-8.

**ATTENTION: Charge battery 6 hours before using.**